



26 Kildonan Close, Nottingham, NG8 6NY

£850 PCM



COMING SOON! A two bedroom house suited for a couple or a small family.

Bright and airy rooms, front and rear gardens, fitted kitchen and security alarm system.

Upon entering the property there is a vast entrance hall with access to the kitchen and the living area with a built in storage cupboard under the stairs and a concealed cloak room cupboard and access to the rear garden via the back door. A fully fitted white gloss kitchen with integrated oven and hob and chimney extractor. Upstairs you have access to Bedrooms 1 & 2 and the bathroom with a cupboard housing the newly fitted combi boiler. The bathroom is of a generous size and provides you with a bath, toilet and sink with an electric shower.

Just a 10 minute walk to the local Asda supermarket and a 6 minute walk to the local newsagents and bus stops for city routes offered by NCT 77/78. Djanogly Strelley Academy just 2 minutes walk from the property and the local social club a further minute walk away.



First Floor

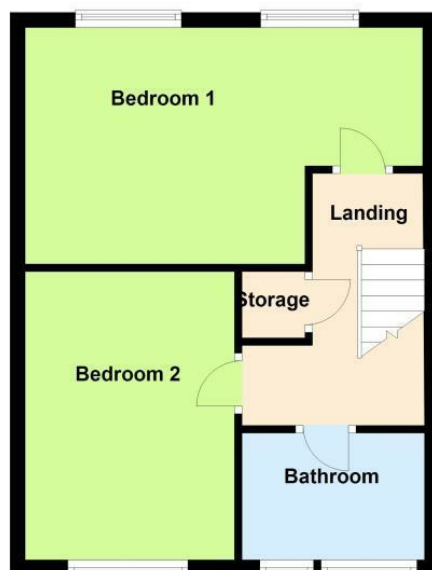

Energy Efficiency Rating		
	Current	Potential
Very energy efficient - lower running costs		
(92 plus) A		85
(81-91) B		
(69-80) C		
(55-68) D	61	
(39-54) E		
(21-38) F		
(1-20) G		
Not energy efficient - higher running costs		
England & Wales EU Directive 2002/91/EC		
Environmental Impact (CO ₂) Rating		
	Current	Potential
Very environmentally friendly - lower CO ₂ emissions		
(92 plus) A		84
(81-91) B		
(69-80) C		
(55-68) D		
(39-54) E	56	
(21-38) F		
(1-20) G		
Not environmentally friendly - higher CO ₂ emissions		
England & Wales EU Directive 2002/91/EC		

These particulars, whilst believed to be accurate are set out as a general outline only for guidance and do not constitute any part of an offer or contract. Intending purchasers should not rely on them as statements of representation of fact, but must satisfy themselves by inspection or otherwise as to their accuracy. No person in this firm's employment has the authority to make or give any representation or warranty in respect of the property.